

Free of lubrication • Free of maintenance • Quiet

APPLICATIONS

- Vacuum filtration.
- Vacuum distillation.
- Rotating evaporators.
- Gas extraction and transport.
- Vacuum drying.

MODEL "MV 50"



CONTROL PANEL

- Vacuum and pressure gauges.
- Adjustable pressure and vacuum.
- Tensile handle for easy transport.
- Button On-Off.

COMUN FEATURES

- Constructed in aluminium.
- Membrane of polifluoropreno, resistant to the corrosion and long-life.
- Refrigeration system that allows a continuous operation of 24 hours.

MODEL "MV 100"



CONTROL PANEL

- Vacuum indicator.
- Vacuum regulator.
- Button On-Off.

MODELS	Part No.	Vacuum Rate m ³ /h	Vacuum Limit mbar	Pressure bar	Heigh / Width / Depth (exterior) cm	Power W	Power supply	Weight Kg
MV 50	5910100	1,8	200	2	23,5 16 21	160	220V/50Hz	8
MV 100	5910101	3,6	200	2,75	23,5 16 30	160	220V/50Hz	9

They are supplied with a 1 meter of silicone tube Ø 8 x 12mm.

Vacuum pump

ROTARY VANE PUMP WITH ANTI RETURN VALVE PREVENTS OIL FLOW BACK, SUITABLE FOR GENERAL LABORATORY APPLICATIONS. OVER TEMPERATURE MOTOR PROTECTION CUT-OUT AND MAIN ON/OFF SWITCH.

FEATURES

- Asbestos veins and internal joints.
- Aspiration connection 16 mm Ø in model 5900620 and 5900621, 25 mm in model 5900622.
- Analogue vacuum gauge.
- High oil volume and forced lubrication.
- Oil reservoir charge capacity: 250 ml in model 5900620, 550 ml in model 5900621 and 1150 ml in model 5900622.
- Exhaust filter and ballast.
- Shock absorber mounted.
- Low noise level (62db)
- Maximum working temperature 60 °C.
- Portable with lifting handle.



Part No. 5900620



Part No. 5900621



Part No. 5900622

MODELS

Part No.	Pump rate m ³ /hr	Vacuum limit mbar	Height / Width / Depth (exterior) cm	r.p.m.	Power W	Weight Kg
5900620	3,6	0,1	23 27 12	1400	120	7,6
5900621	3,6	0,00	27 35 14	1400	180	11
5900622	7,2	0,0006	34 49 15	1400	370	21

ACCESSORY

- High pressure rubber tubes of 18 x 26 mm Ø. Part No 5900624
- High pressure rubber tubes of 8 x 15 mm Ø. For Vacuum oven connection "VACIOTEM". Part No 5900625
- Pump oil for vacuum pumps, 1 litre bottle. Part No. 5515030

SPARE Vacuum gauge (Fits both models), Part No. 5515031

FEATURES

Transfer, evacuation and compression, free from contamination. The models N-86 and N-022 of 2.5 and 4 bar of relative pressure, can be used also as a compressor.

- Can be operated dry.
- No lubrication required.
- Maintenance free.
- Silent.

The double head models are made with linear two phase membranes.

All Models (except model N-022), are made with a patented system of diaphragms manufactured with optimum tension, that results in a smaller more durable pump.

Approximate loss 6×10^{-3} mbar x L/s

Complete with thermal breaker and fuse.

Medium to high resistance to chemicals, (model dependant).

We advise that you check the compatibility of the pump performance with the materials that will be in contact with the pump parts (see table).



MODELS / SPECIFICATIONS	N-86	N-022	N-816	N-820	N-840
Part No.	5910106	5910107	5910108	5910009	5910110
Vacuum pump rate (to 1 Atm, of pressure)	5.5 l/min	13 l/min	16 l/min	20 l/min	34 l/min
	0.33 m ³ /h	0.78 m ³ /h	0.96 m ³ /h	1.2 m ³ /h	2.04 m ³ /h
Vacuum limit (mbar) absolute	160 mbar	100 mbar	20 mbar	8 mbar	8 mbar
Pressure (bar) relative	2.5 bar	4 bar	0.5 bar	1 bar	1 bar
Tube connection, Ø interior	4 mm	6 mm	6 mm	10 mm	10 mm
Number of heads and phases	1	1	2	2	2
Head material	PPS	Aluminium	PPS	PTFE	PTFE
Membrane material (diaphragms)	PTFE	PTFE	PTFE	PTFE	PTFE
Valve material	FFPM	Stainless steel	FFPM	FFPM	FFPM
Motor protection level	IP-20	IP-20	IP-20	IP-44	IP-44
Gas operating temperature and permissible ambient	5 to 40 °C				
Current (A) / Power (W)	0.63 / 65	0.7 / 100	0.6 / 100	0.7 / 120	1.5 / 245
Dimensions height x width x depth (cm)	14 x 9 x 17	19 x 15 x 20	14 x 9 x 36	21 x 15 x 31	23 x 17 x 34
Weight (Kg)	1.9	4	3.95	9.3	12.6

APPLICATIONS AND CHEMICAL RESISTANCE	N-86	N-022	N-816	N-820	N-840
Chemical resistance (depends on medium being pumped.)	medium-high	medium-high	medium-high	medium-high	medium-high
For gasses and vapours very aggressive or corrosive	-	-	-	Yes	Yes
For gasses and vapours slightly aggressive or corrosive	Yes	Yes	Yes	Yes	Yes
For liquid transfer and evacuation	Yes	Yes	Yes	Yes	-
For liquid transfer, evacuation and as a compressor	Yes	Yes	-	-	-
Ideal for vacuum filtration	Yes	Yes	Yes	Yes	Yes
Ideal for vacuum filtration, evaporation, drying and gel drying	-	-	-	Yes	Yes

SPARE PARTS	N-86	N-022	N-816	N-820	N-840
Spares Kit: 1 membrane +2 valves + 2 gaskets	5910120	-	-	-	-
Spares Kit: 1 membrane +2 valves + 1 gasket	-	5910121	-	-	-
Spares Kit: 2 membrane +4 valves + 4 gaskets	-	-	5910122	5910123	5910124

COMECTA Silicon tube for peristaltic and membrane pumps

MODELS

	Part No.	interior Ø mm	exterior Ø mm
Standard tube*	8991202*	4	7
	8991201*	6	9
	8991200*	8	11



	Part No.	interior Ø mm	exterior Ø mm
Calibrated tubing*	5253300*	0.8	4
	5253400*	1.7	4.9
	0686203	3	7
	5253600*	3.1	6.3
	5253500	4.8	9.8
	0686210	5	9
	5253900	6.3	11.3
	0686216	8	12

(*) Tubing supplied in 1 meter lengths.

(*) Part Numbers with asterisk* are adaptables to peristaltic pumps "Percom N-M II" and "PR-2003". See page 47

COMECTA Sink weights and glass connections

FOR CENTRIFUGAL AND PERISTALTIC PUMPS.

FEATURES

Made of glass.

Adapters for centrifugal and peristaltic pumps.

For better aspiration and dispensing.



A. Sink weight "ASPIPUMP"

Surface olive that fixes to the tube. The sink weight maintains the tube at the bottom of the vessel being used for the aspirant liquid. Part No. Tube size

5991204	4 mm Ø interior.
5991206	6 mm Ø interior.
5991208	8 mm Ø interior.

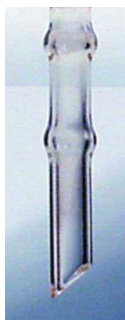

B. Spout "PECIPUMP"

Surface olive is pushed onto the inside of the dispensing end of the tube, liquids can then be dispensed easily and accurately. Part No. Tube size

5991203	4 mm Ø interior.
5991205	6 mm Ø interior.
5991207	8 mm Ø interior.

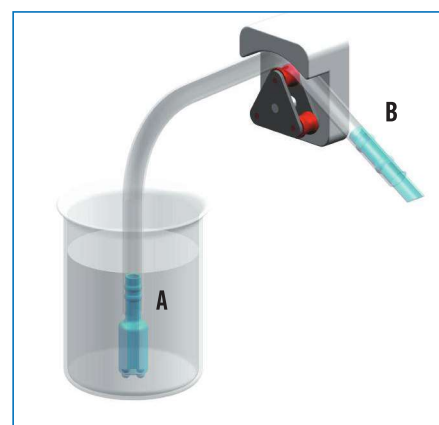

A. Sink weight "ASPIPUMP" an efficient way to aspirate to the last drop.

B. Spout "PECIPUMP" an exact way to dispense.



Membrane vacuum pump "Vacum-Sel"

FEATURES

Small footprint, bench top.

Quiet and vibration free.

Maximum working temperature: 40 °C.

CONTROL PANEL

Mains power switch.

Vacuum gauge, scale 0 to -1 bar.

Vacuum in.

Air out.

MODEL

Part No.	Pump Rate litres/min.	Vacuum limit	Height / Width / Depth (exterior) cm	Power W	Weight Kg
3001001	1.08	-0.6 bar ≈ 440 mm Hg	19 14 19	35	3



Membrane vacuum and pressure pump "Vacum-Pres"

FEATURES

Small footprint, bench top.

Quiet and vibration free.

Maximum working temperature: 40 °C.

CONTROL PANEL

Mains power switch.

Vacuum gauge, scale 0 to -1 bar.

Pressure gauge, scale 0 to 2.5 bar.

Control for pressure/vacuum.

Vacuum in.

Pressure out.

MODEL

Part No.	VACUUM		Pressure		Height / Width / Depth (exterior) cm	Power W	Weight Kg
	Pump Rate /min.	Vacuum limit	Pressure Rate /min.	Max. Pressure			
3001002	1.08	-0.6 bar=440 mm Hg	1.3	1.2 bar	19 14 19	35	3.2

